

QUICK START GUIDE

Room 422 Hastings Hall Thomas Nelson Community College

USING THE PROJECTOR

1. Log into the PC
2. Power on Projector
(The default image source is the PC)



CONTROLLING AUDIO

1. Turn On Speakers



2. Adjust tone and volume as needed

USING INTERACTIVE WHITEBOARD

1. Press the "Whiteboard" button on the wall control panel

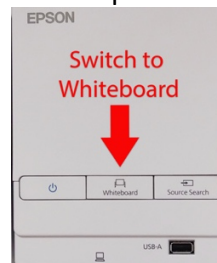

2. Use interactive pens, fingers, dry erase markers.

Please NO SHARPIES or PERMANENT MARKERS

USING THE EPSON DOC CAMERA

1. Turn on the Power
(Power indicator light will be blue when on)



2. Select the "Easy Interactive" Tools icon from the desktop



3. Select the camera option from the menu

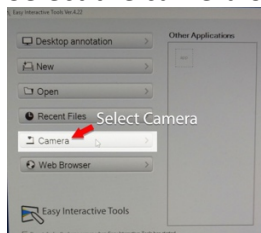

4. Select the "full screen" icon to display the image across the full screen.

ADDITIONAL ASSISTANCE

Call the IT Help Desk at Extension 2709